

NOTE:
Please read all instructions
carefully before using this
product

Table of Contents

Safety Notice

Hardware Identifier

Assembly Instruction

Parts List

Warranty

Ordering Parts

Model
MB-2000

Retain This
Manual for
Reference

12-05-07

OWNER'S
MANUAL

MONKEY BAR

MB-2000

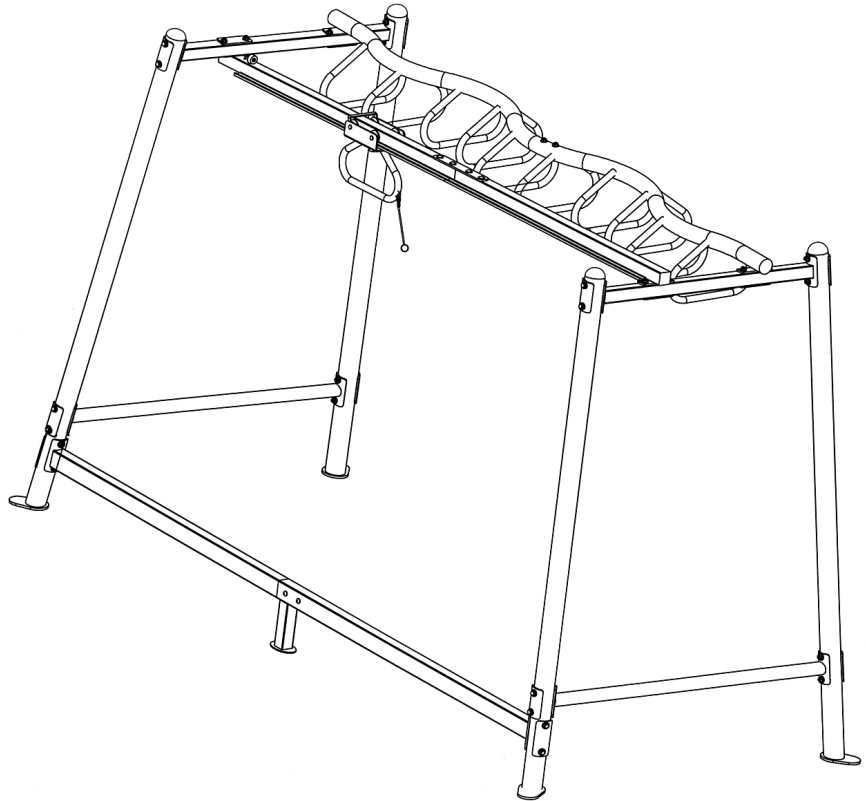

IMPEX® INC.

14777 DON JULIAN RD., CITY OF INDUSTRY, CA 91746

Tel: (800) 999-8899 Fax: (626) 961-9966

www.impex-fitness.com

info@impex-fitness.com

TABLE OF CONTENTS

BEFORE YOU BEGIN.....	1
IMPORTANT SAFETY NOTICE.....	3
HARDWARE IDENTIFIER.....	5
ASSEMBLY INSTRUCTIONS.....	6
EXPLODED DIAGRAM.....	12
PARTS LIST.....	13
WARRANTY.....	14
ORDERING PARTS.....	14

BEFORE YOU BEGIN

Thank you for selecting the MONKEY BAR MB-2000 by IMPEX®. For your safety and benefit, read this manual carefully before using the machine. As a manufacturer, we are committed to provide you complete customer satisfaction. If you have any questions, or find there are missing or damaged parts, we guarantee you complete satisfaction through direct assistance from our factory. **DO NOT RETURN THE UNIT TO THE STORE!** To avoid unnecessary delays, please call our *TOLL-FREE customer service number*. Our Customer Service Agents will provide immediate assistance to you.

Toll-Free Customer Service Number

1-800-999-8899

Mon. – Fri. 9 a.m. – 5 p.m. PST

www.impex-fitness.com

info@impex-fitness.com

WARNING LABEL PLACEMENT

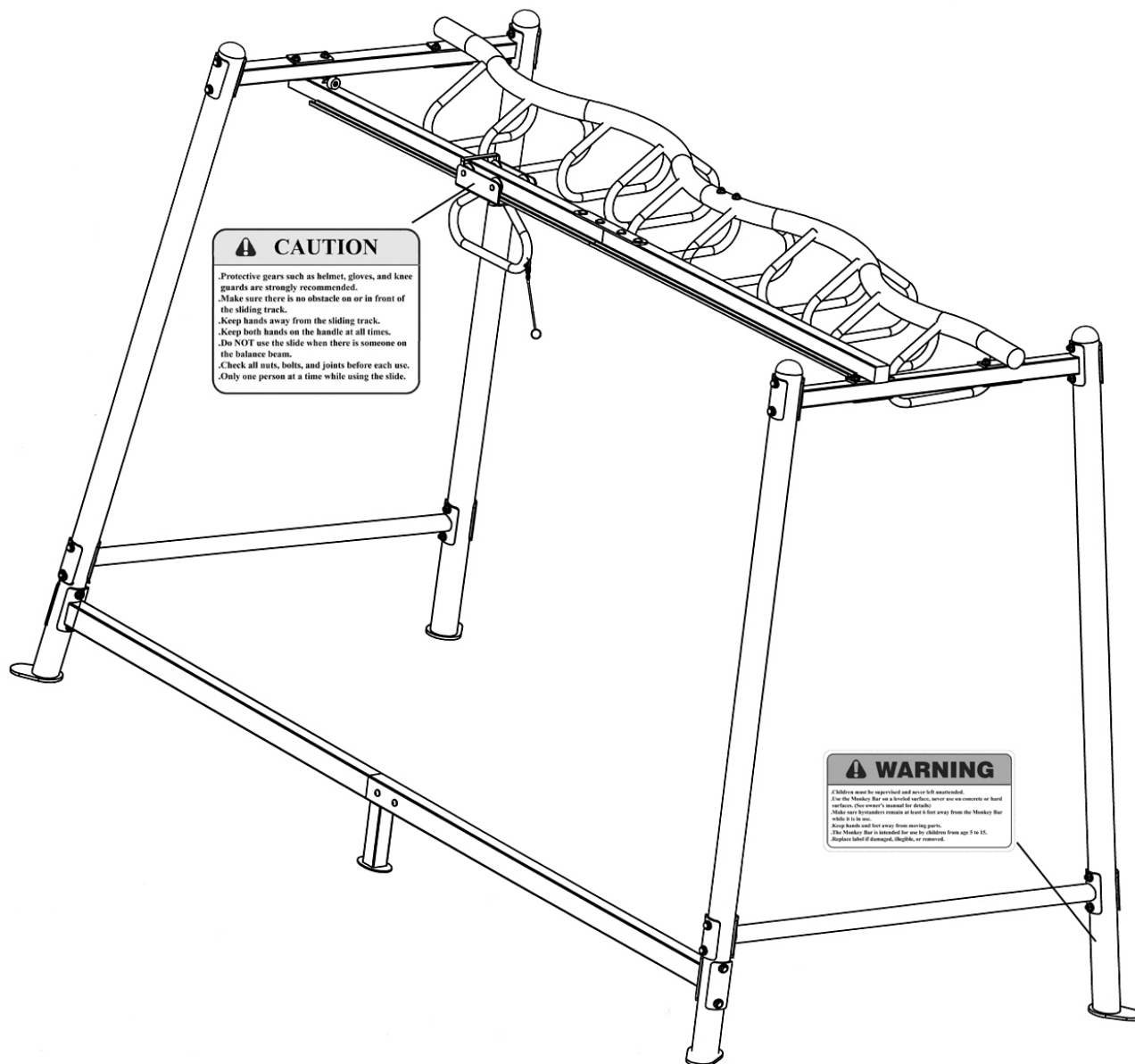

The warning label and caution label have been placed on the unit in location shown. If the labels are missing or illegible, please call customer service at 1-800-888-8899 for replacement. Apply the labels in location shown.

IMPORTANT SAFETY NOTICE

This playground equipment is built for optimum safety. However, certain precautions apply whenever you operate a piece of playground equipment. Be sure to read the entire manual before you assemble or operate your equipment. In particular, observing the following safety precautions and warnings to reduce the likelihood of serious or fatal injury.

1. Children of all ages must be supervised at all times and never left unattended with the unit.
2. Do not install the equipment over concrete, asphalt, packed earth, grass, carpet or any other hard surface. A fall onto a hard surface can result in serious injury to the user.
3. Make sure the surfaces are free of objects that may cause tipping over.
4. This Monkey Bar is for outdoor use only.
5. Place the equipment on level ground, not less than 6 ft (1.8 m) from any structure or obstruction such as fence, garage, house, overhanging branches, laundry lines, or electrical wires.
6. Locate the Monkey Bar away from swings or use a guardrail or barrier to separate the Monkey Bar from the movement of the swings.
7. Do not use the Monkey Bar when it is wet.
8. Children should not wear ponchos, scarfs, and other loose-fitting clothing. Attire should include well-fitting shoes.
9. This Monkey Bar is intended for use by children from ages 5 to 15.
10. This Monkey Bar is not designed for handicap children.
11. Maximum weight for a single user is 200 lbs.
12. Maximum of 2 users are allowed using the Monkey Bar at the same time.
13. Impact-absorbing material must be placed inside and around the Monkey Bar. Please refer to the PLAYGROUND SURFACING MATERIALS in page 4.
14. Maximum fall height: 70 inches.
15. To prevent serious injury, children must NOT use the equipment until properly installed.
16. To prevent serious injury, parents must make warnings and instructions to children not to use this equipment in a manner other than intended.
17. To prevent serious injury, parents must make warnings and instructions to children not to attach items to the equipment that are not specifically designed for use with the equipment.
18. Protective gears such as helmet, gloves, and knee guards are strongly recommended while using the equipment.
19. Make sure there is no obstacle on or in front of the sliding track.
20. Keep hands away from the sliding track.
21. Keep both hands on the sliding handle.
22. Do not use the slide when someone is on the balance beam.
23. Only one person at a time while using the slide.
24. Locate the Monkey Bar out of direct sunlight to reduce the likelihood of serious burns.

Care and Maintenance

1. Periodically inspect all parts. Check all nuts and bolts twice monthly during the usage season for tightness and tighten as required. It is particularly important that this procedure be followed at the beginning of each season.
2. Replace any worn and damaged part immediately.
3. Cover the equipment with tarp when left outdoor.
4. Use mild household spray cleaners and/or a damp rag to wipe clean. Do not use harsh cleaning chemicals.
5. Sand rusted areas on tubular members and repaint using a non-lead based paint meeting the requirements of Title 16 CFR Part 1303.
6. Rake surfacing periodically to prevent compaction and maintain appropriate depths.
7. Disposal Instructions – The equipment can be safely disassembled and disposed without unreasonable hazards. Call your local recycle agency regarding details of recycling.

SAVE THESE INSTRUCTIONS.

CONSUMER INFORMATION SHEET FOR PLAYGROUND SURFACING MATERIALS

The U.S. Consumer Product Safety Commission (CPSC) estimates that about 100,000 playground equipment-related injuries resulting from falls to the ground surface are treated annually in U.S. hospital emergency rooms. Injuries involving this hazard pattern tend to be among the most serious of all playground injuries, and have the potential to be fatal, particularly when the injury is to the head. The surface under and around playground equipment can be a major factor in determining the injury-causing potential of a fall. It is self evident that a fall onto a shock absorbing surface is less likely to cause a serious injury than a fall onto a hard surface. Playground equipment should never be placed on hard surfaces such as concrete or asphalt and while grass may appear to be acceptable it may quickly turn to hard packed earth in areas of high traffic. Shredded bark mulch, wood chips, fine sand or fine gravel are considered to be acceptable shock absorbing surfaces when installed and maintained at a sufficient depth under and around playground equipment.

The following table lists the maximum height from which a child would not be expected to sustain a life-threatening head injury in a fall onto four different loose-fill surfacing materials if they are installed and maintained at depths of 6, 9, and 12 inches. However, it should be recognized that all injuries due to falls cannot be prevented no matter what surfacing material is used.

FALL HEIGHT IN FEET FROM WHICH A LIFE THREATENING HEAD INJURY WOULD NOT BE EXPECTED			
TYPE OF MATERIAL	6-INCH DEPTH	9-INCH DEPTH	12-INCH DEPTH
Double Shredded Bark Mulch	6	10	11
Wood Chips	6	7	12
Fine Sand	5	5	9
Fine Gravel	6	7	10

It is recommended that a shock absorbing material should extend a minimum of 6 feet in all directions from the perimeter of stationary equipment such as climbers and slides. However, because children may deliberately jump from a moving swing, the shock absorbing material should extend in the front and rear of a swing a minimum distance of 2 times the height of the pivot point measured from a point directly beneath the pivot on the supporting structure.

This information is intended to assist in comparing the relative shock-absorbing properties of various materials. No particular material is recommended over another. However, every material is only effective when properly maintained. Materials should be checked periodically and replenished to maintain correct depth as determined necessary for your equipment. The choice of a material depends on the type and height of the playground equipment, the availability of the material in your area, and its cost.

This information has been extracted from the CPSC publications "Playground Surfacing - Technical Information Guide" and "Handbook for Public Playground Safety." Copies of these reports can be obtained by sending a postcard to the: Office of Public Affairs, U.S. Consumer Product Safety Commission, Washington, D.C., 20207 or call the toll-free hot line: 1-800-638-2772.

HARDWARE IDENTIFIER

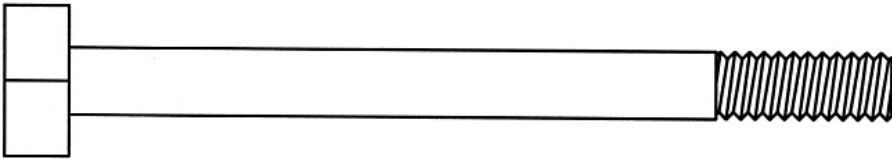

#27 M12 x 4 $\frac{1}{8}$ " Hex Bolt (Qty 20)

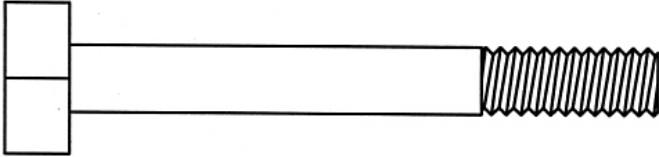

#28 M12 x 3" Hex Bolt (Qty 10)

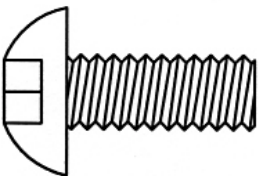

#29 M10 x $\frac{3}{4}$ " Allen Bolt (Qty 8)

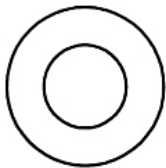

#32 $\varnothing \frac{3}{4}$ " Washer
(Qty 8)

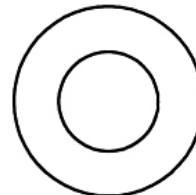

#33 $\varnothing 1$ " Washer
(Qty 16)

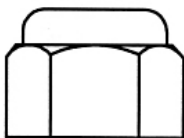

#34 M12 Aircraft Nut
(Qty 30)



#30 $\varnothing 1$ " Curved Washer
(Qty 44)

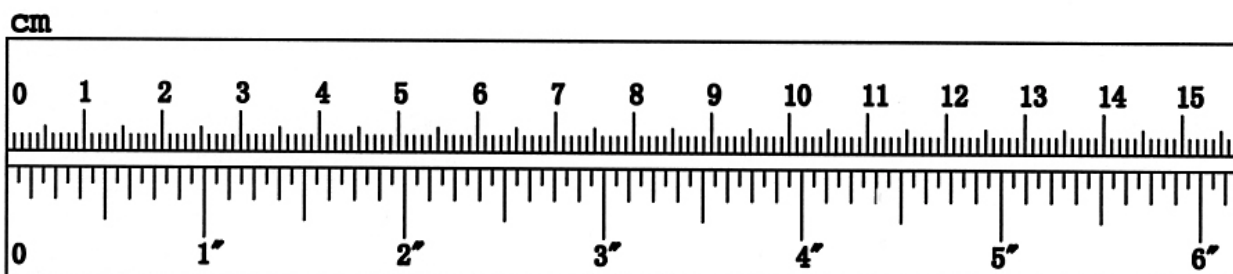

ASSEMBLY INSTRUCTION

Tools Required Assembling the Machine: Two Adjustable Wrenches and one Allen Wrench.
NOTE: It is strongly recommended two or more people assembling this equipment to avoid possible injury.

STEP 1 (See Diagram 1)

- A.) Do not tighten Nuts and Bolts until instructed to do so.
- B.) Connect the Upright Post-1 (#1) and Upright Post-3 (#3) with a Lower Cross Brace (#5) in the mid-span. Secure each end with two M12 x 4 1/8" Hex Bolts (#27), one Curved Bracket (#15), four Ø 1" Curved Washers (#30), and two M12 Aircraft Nuts (#34).
- C.) Connect the Upright Post-1 and Upright Post-3 with an Upper Cross Brace (#6) on the top. Secure each end with two M12 x 4 1/8" Hex Bolts (#27), one Curved Bracket (#15), four Ø 1" Curved Washers (#30), and two M12 Aircraft Nuts (#34).

DIAGRAM 1

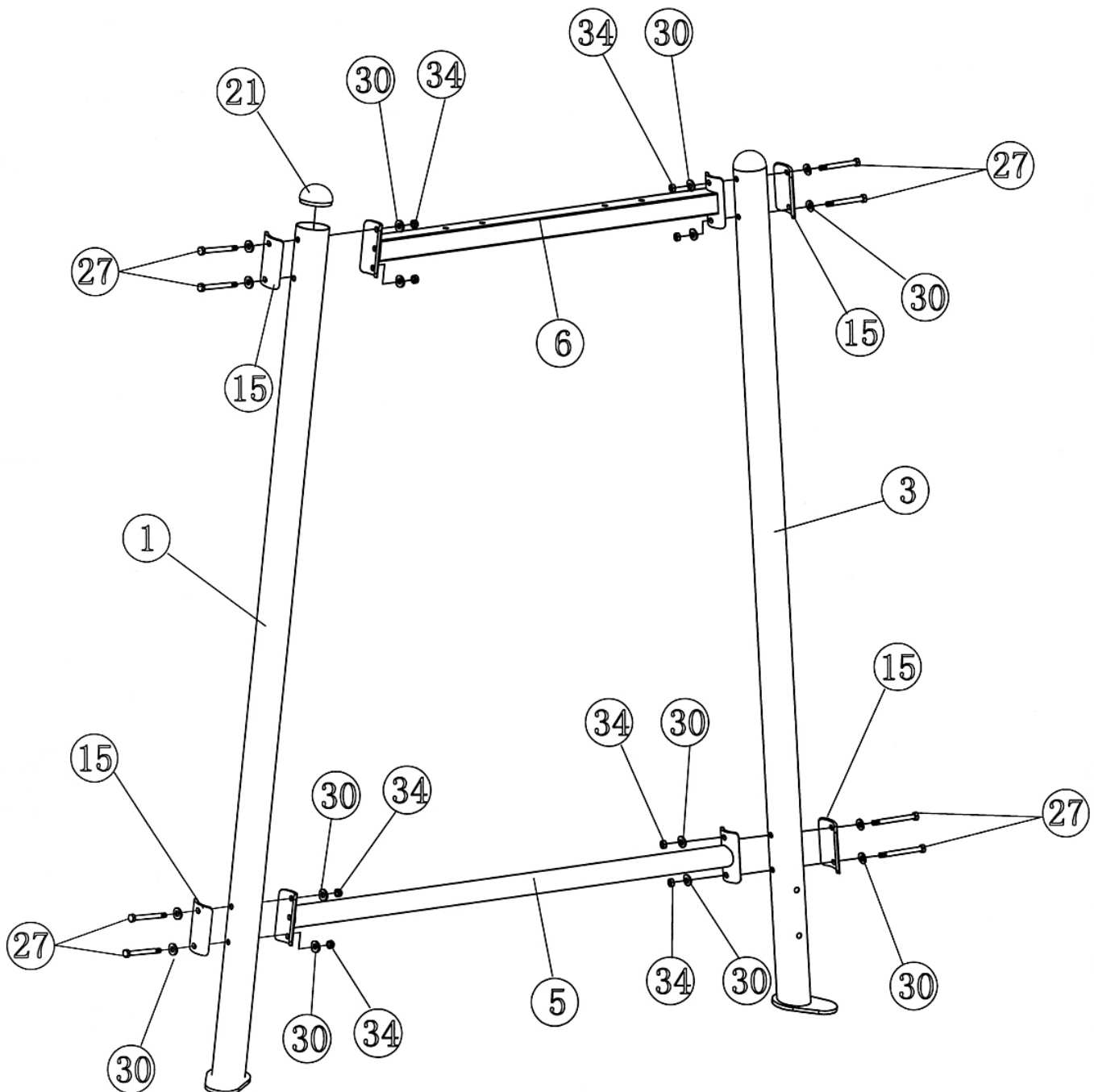

Step 2 (See Diagram 2)

- A.) Connect Upright Post-2 (#2) and Upright Post-4 (#4) with a Lower Cross Brace (#5) in the mid-span. Secure each end with two M12 x 4 1/8" Hex Bolts (#27), one Curved Bracket (#15), four Ø 1" Curved Washers (#30), and two M12 Aircraft Nuts (#34).
- B.) Connect Upright Post-2 (#2) and Upright Post-4 (#4) with an Upper Cross Brace (#6) on the top. Secure each end with two M12 x 4 1/8" Hex Bolts (#27), one Curved Bracket (#15), four Ø 1" Curved Washers (#30), and two M12 Aircraft Nuts (#34).

DIAGRAM 2

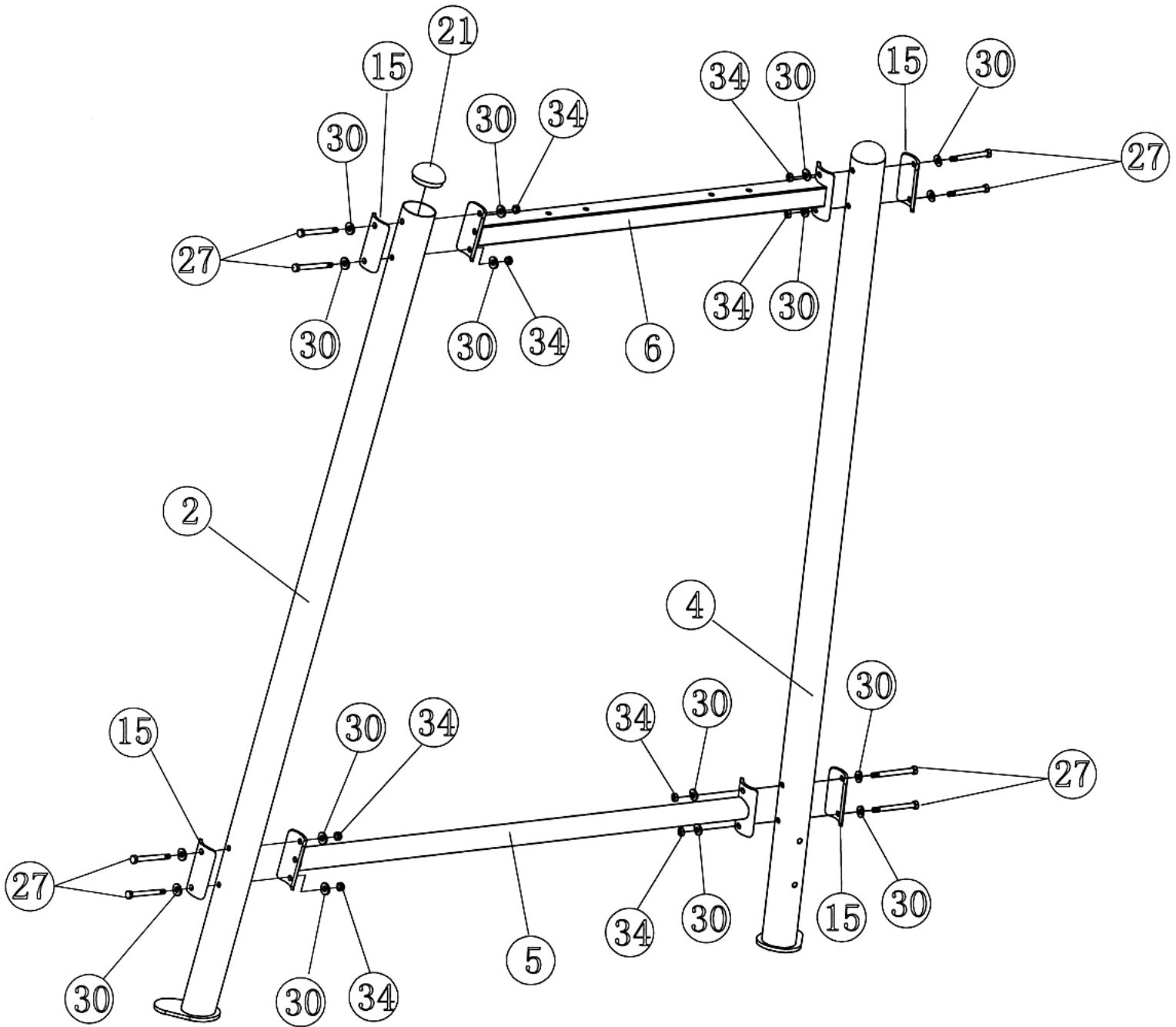

Step 3 (See Diagram 3)

- A.) Insert the Left Balance Beam (#12) into the Right Balance Beam (#11). Align the holes and secure them together with four M10 x $\frac{3}{4}$ " Allen Bolts (#29) and $\varnothing \frac{3}{4}$ " Washers (#32).
- B.) Attach the Left Balance Beam to the Upright Post-4 (#4). Secure it with two M12 x 4 $\frac{1}{8}$ " Hex Bolts (#27), one Large Curved Bracket (#16), four $\varnothing 1$ " Curved Washers (#30), and two M12 Aircraft Nuts (#34).
- C.) Repeat Procedure B above to connect the Right Balance Beam (#11) to the Upright Post-3 (#3).

DIAGRAM 3

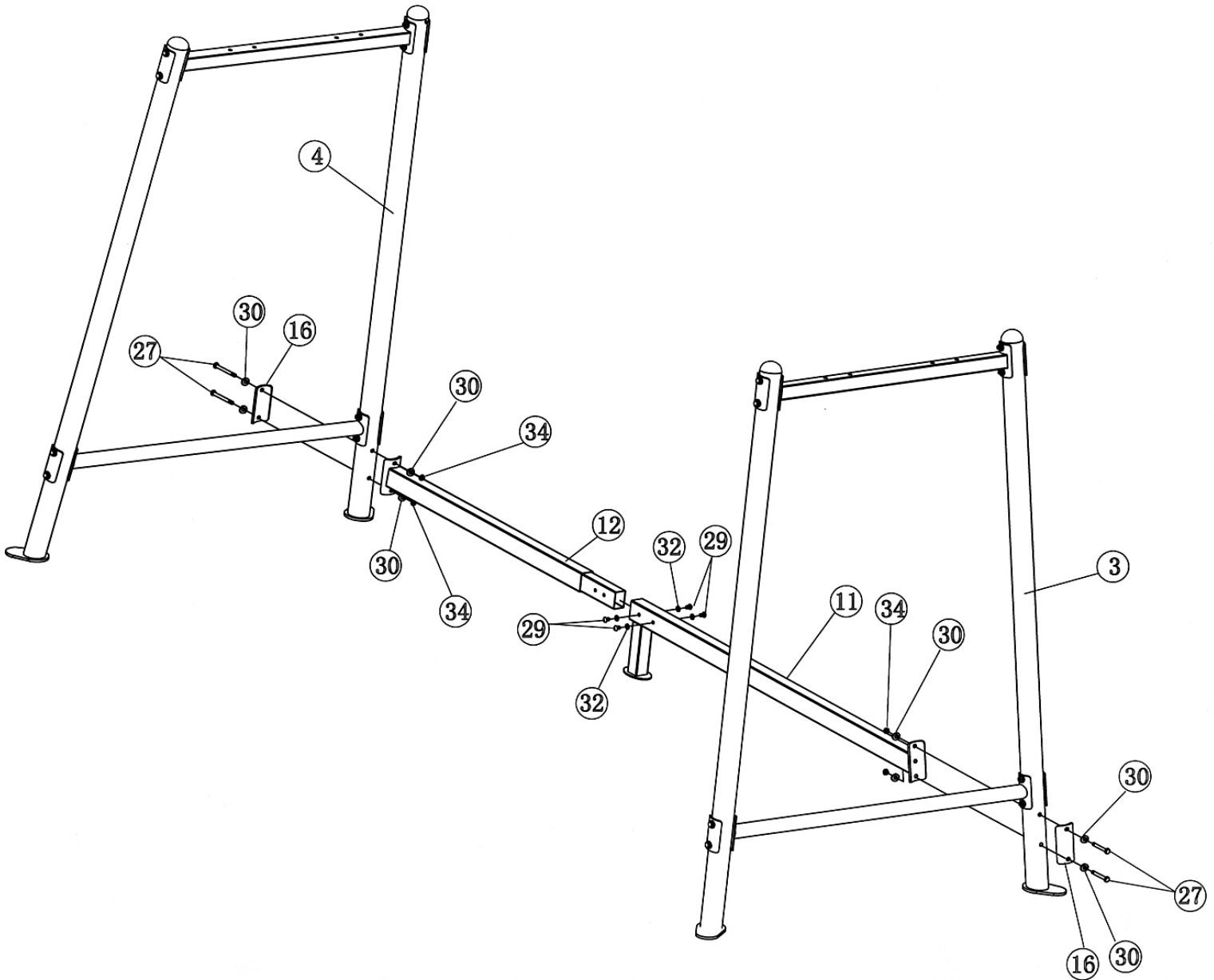

Step 4 (See Diagram 4)

- A.) Insert the Left Monkey Bar (#8) into the Right Monkey Bar (#7).
- B.) Align the holes and secure them together with two M12 x 3" Hex Bolts (#28), four Ø 1" Curved Washers (#30), and two M12 Aircraft Nuts (#34).

DIAGRAM 4

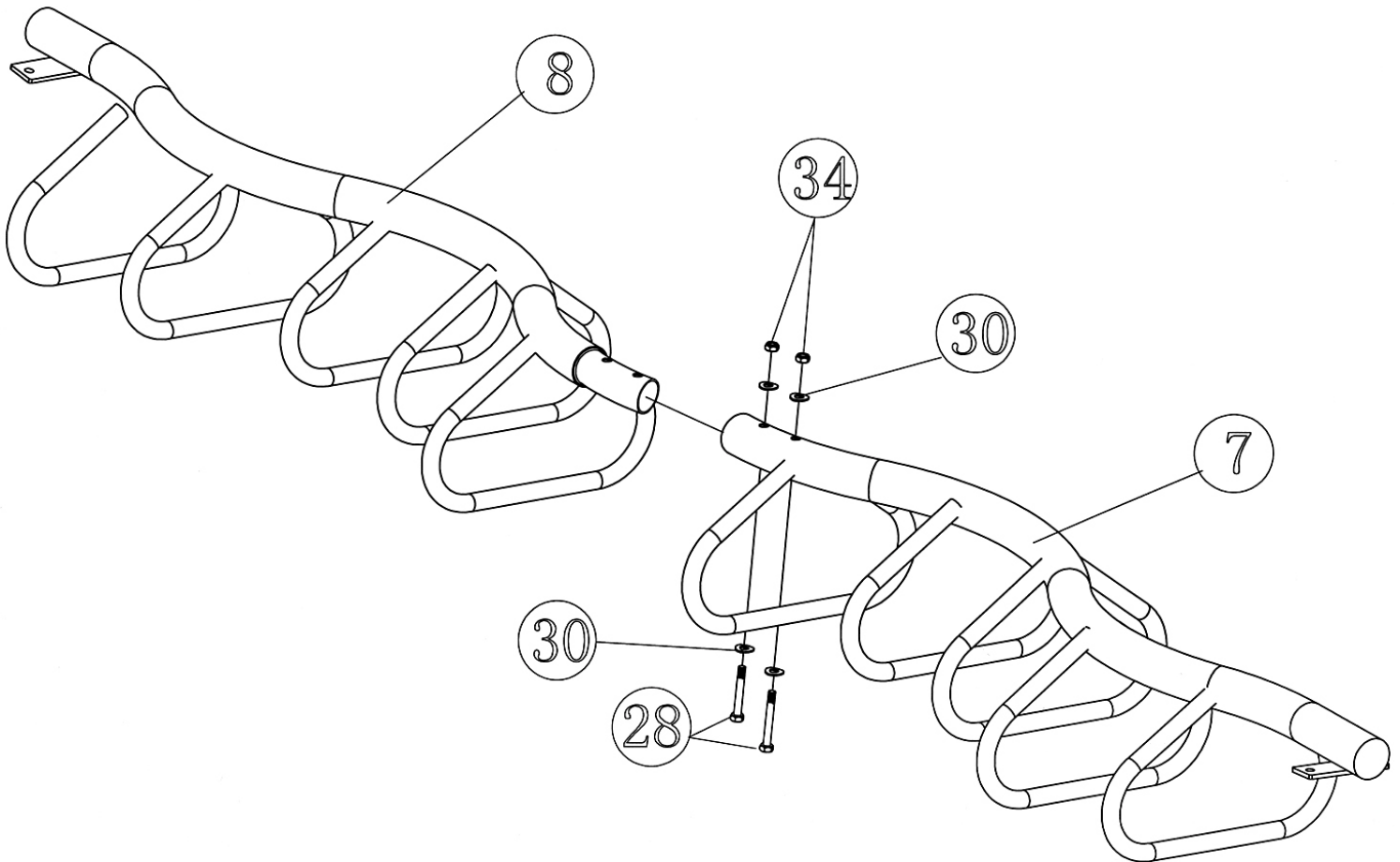

Step 5 (See Diagram 5)

- A.) Slide the Sliding Carriage (#13) onto the Left Sliding Track (#9).
- B.) Insert the Right Sliding Track (#10) into the Left Sliding Track. Secure them together with four M10 x $\frac{3}{4}$ " Allen Bolts (#29), one Large Flat Bracket (#17), and four $\varnothing \frac{3}{4}$ " Washers (#32).

DIAGRAM 5

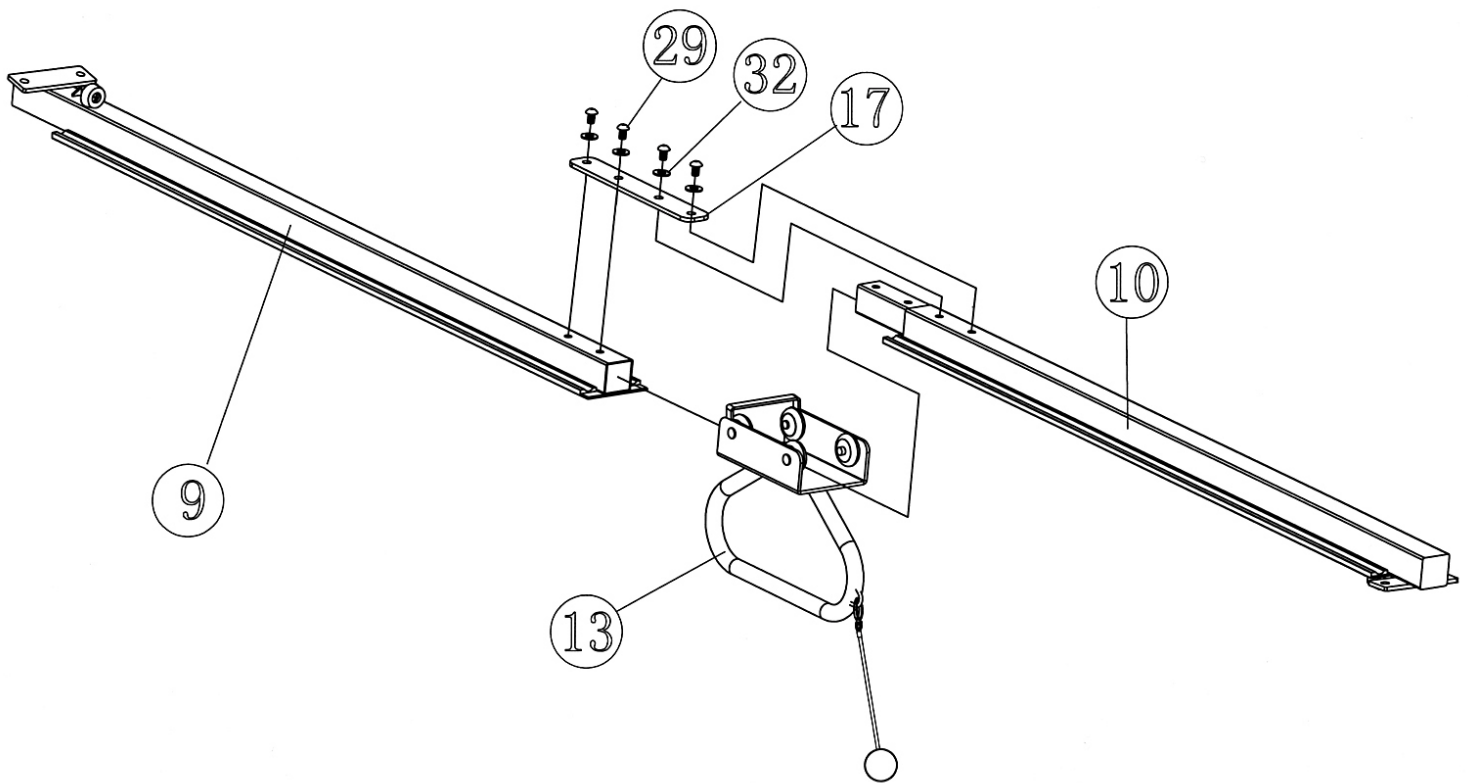

Step 6 (See Diagram 6)

- A.) Place the Right & Left Monkey Bars (#7 & #8) onto the Upper Cross Brace (#6).
- B.) Secure each end with two M12 x 3" Hex Bolts (#28), one Flat Bracket (#14), four Ø 1" Washers (#33), and two M12 Aircraft Nuts (#34).
- C.) Place the end of Right Sliding track (#10) on top of the Upper Cross Brace. Secure it with two M12 x 3" Hex Bolts (#28), one Flat Bracket (#14), four Ø 1" Washers (#33), and two M12 Aircraft Nuts (#34).
- D.) Attach the end of Left Sliding Track (#9) to the bottom of Upper Cross Brace. Secure it with two M12 x 3" Hex Bolts (#28), one Flat Bracket (#14), four Ø 1" Washers (#33), and two M12 Aircraft Nuts (#34).
- E.) Securely tighten all Nuts and Bolts previously installed.
- F.) Use the Rope (#24) to pull the Sliding Carriage (#13) to the Magnets (#25) at end of the Right Sliding Track as the starting position.

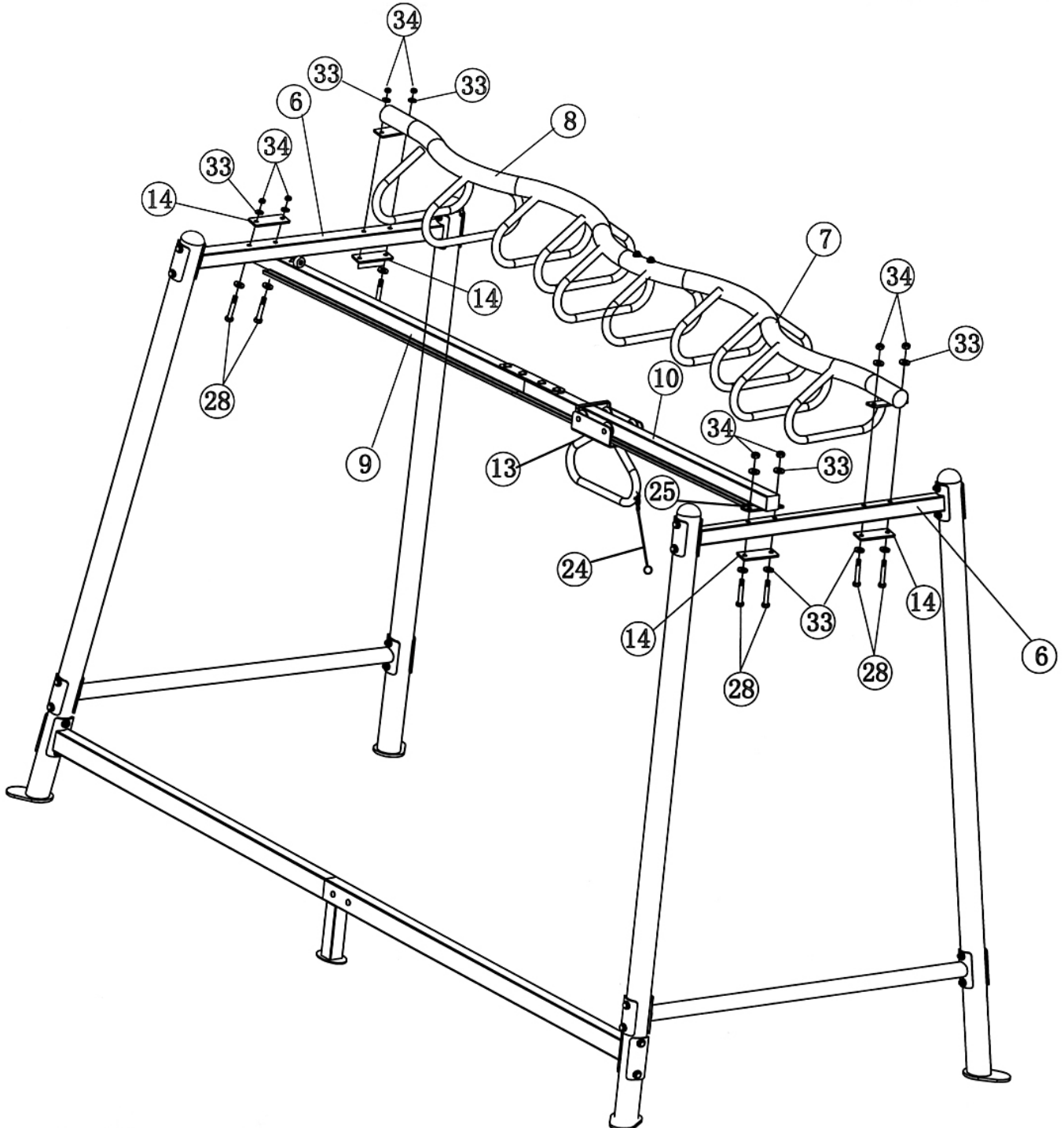

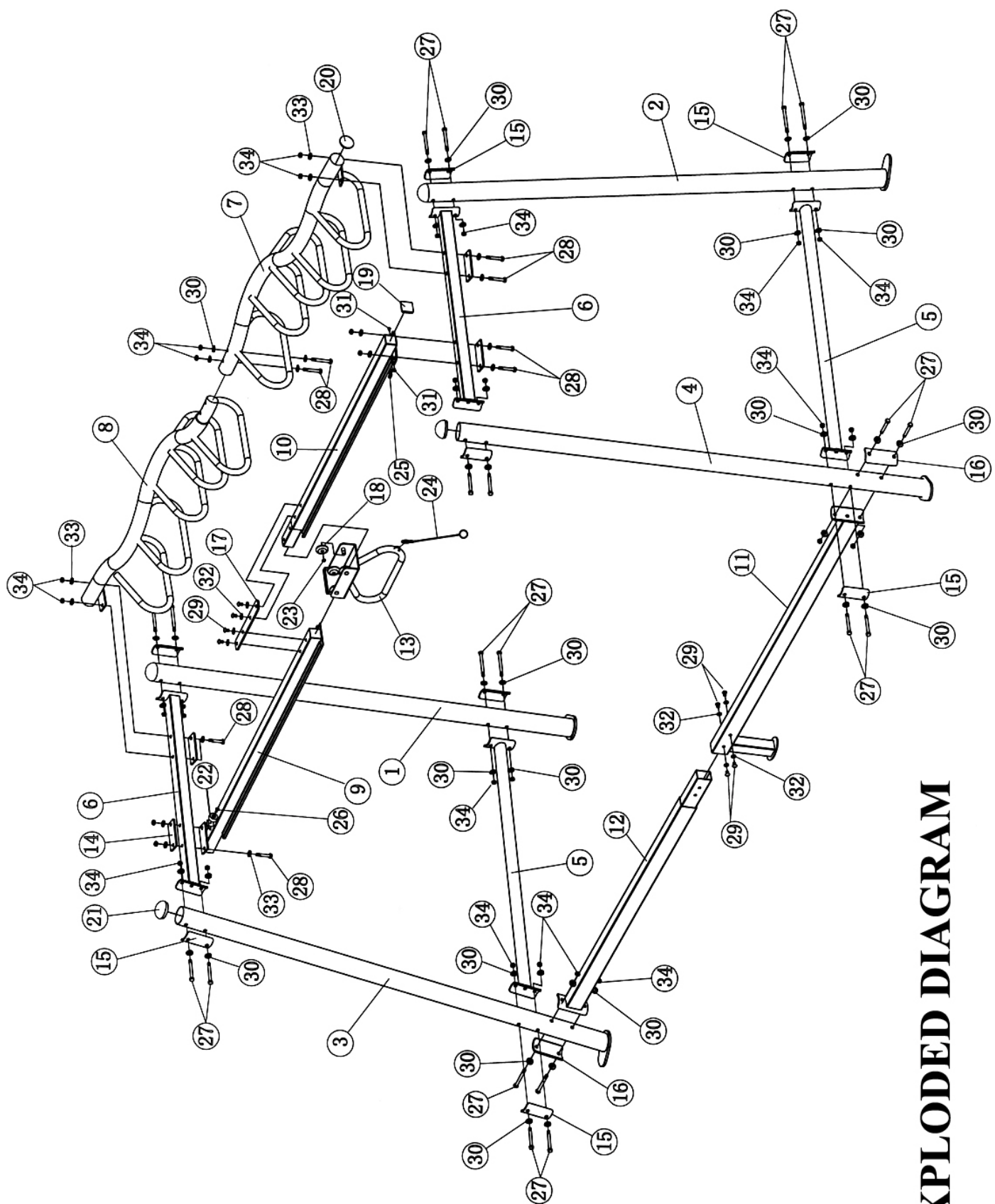

EXPLODED DIAGRAM

Parts list

KEY NO.	DESCRIPTION	Q'ty
1	Upright Post-1	1
2	Upright Post-2	1
3	Upright Post-3	1
4	Upright Post-4	1
5	Lower Cross Brace	2
6	Upper Cross Brace	2
7	Right Monkey Bar	1
8	Left Monkey Bar	1
9	Left Sliding Track	1
10	Right Sliding Track	1
11	Right Balance Beam	1
12	Left Balance Beam	1
13	Sliding Carriage	1
14	Flat Bracket	4
15	Curved Bracket	8
16	Large Curved Bracket	2
17	Large Flat Bracket	1
18	Wheel	4
19	2" Square End Cap	2
20	Ø 2 3/8" End Cap	2
21	Ø 3" Cone-shaped End Cap	4
22	Rubber Bumper	1
23	E-clip	4
24	Rope	1
25	Magnet	4
26	M6 x 5/8" Philips Screw	1
27	M12 x 4 1/8" Hex Bolt	20
28	M12 x 3" Hex Bolt	10
29	M10 x 3/4" Allen Bolt	8
30	Ø 1" Curved Washer	44
31	M6 x 3/8" Allen Bolt	2
32	Ø 3/4" Washer	8
33	Ø 1" Washer	16
34	M12 Aircraft Nut	30

IMPEX[®] INC.

LIMITED WARRANTY

IMPEX INC ("IMPEX[®]") warrants this product to be free from defects in workmanship and material, under normal use and service conditions, for a period of 2 YEARS from the date of purchase. This warranty extends only to the original purchaser. IMPEX's obligation under this Warranty is limited to replacing or repairing, at IMPEX's option.

All returns must be pre-authorized by IMPEX. Pre-authorization may be obtained by calling IMPEX Customer Service Department at 1-800-999-8899. All freights on products returned to IMPEX must be prepaid by the customer. This warranty does not extend to any product or damage to a product caused by or attributable to freight damage, abuse, misuse, improper or abnormal usage or repairs not provided by an IMPEX authorized service center or for products used for heavy commercial or rental purposes. No other warranty beyond that specifically set forth above is authorized by IMPEX.

IMPEX is not responsible or liable for indirect, special or consequential damages arising out of or in connection with the use or performance of the product or other damages with respect to any economic loss, loss of property, loss of revenues or profits, loss of enjoyments or use, costs of removal, installation or other consequential damages or whatsoever natures. Some states do not allow the exclusion or limitation of incidental or consequential damages. Accordingly, the above limitation may not apply to you.

The warranty extended hereunder is in lieu of any and all other warranties and any implied warranties of merchantability or fitness for a particular purpose is limited in its scope and duration to the terms set forth herein. Some states do not allow limitations on how long an implied warranty lasts. Accordingly, the above limitation may not apply to you.

This warranty gives you specific legal right. You may also have other rights which vary from state to state. Register on-line at www.impex-fitness.com

IMPEX[®] INC.
14777 Don Julian Rd.,
City of Industry, CA 91746

ORDERING REPLACEMENT PARTS

Replacement parts can be ordered by calling our Customer Service Department toll-free at **1-800-999-8899** during our regular business hours: Monday through Friday, 9 am until 5 pm Pacific standard time.

info@impex-fitness.com

When ordering replacement parts, always give the following information.

1. Model
2. Description of Part
3. Part Number
4. Date of Purchase